



FAG

**6018**

Deep groove ball bearing

Schaeffler ID:  
0167182670000Deep groove ball bearing 60, single row,  
steel sheet metal cage

## Technical information

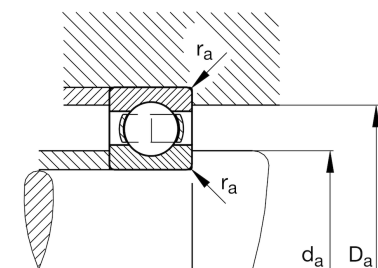
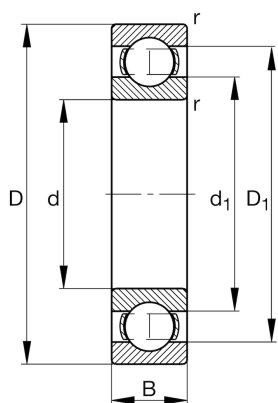
**Main Dimensions & Performance Data**

d	90 mm	Bore diameter
D	140 mm	Outside diameter
B	24 mm	Width
$C_r$	62.000 N	Basic dynamic load rating, radial
$C_{0r}$	49.500 N	Basic static load rating, radial
$C_{ur}$	3.000 N	Fatigue load limit, radial
$n_G$	6.600 1/min	Limiting speed
$n_{gr}$	5.600 1/min	Reference speed
	1,21 kg	Weight

**Dimensions**

$r_{min}$	1,5 mm	Minimum chamfer dimension
$D_1$	124,5 mm	Shoulder diameter outer ring
$d_1$	106,6 mm	Shoulder diameter inner ring

**Mounting dimensions**

$d_{a min}$	97 mm	Minimum diameter shaft shoulder
$D_{a max}$	133 mm	Maximum diameter of housing shoulder
$r_{a max}$	1,5 mm	Maximum fillet radius

**Calculation factors**

$f_0$	15,5	Calculation factor
-------	------	--------------------

**Temperature range**

$T_{min}$	-30 °C	Operating temperature min.
$T_{max}$	150 °C	Operating temperature max.